

ATORNILLADOR RECTO c/embrague M-8

Modelo: **CY 9 PR1**

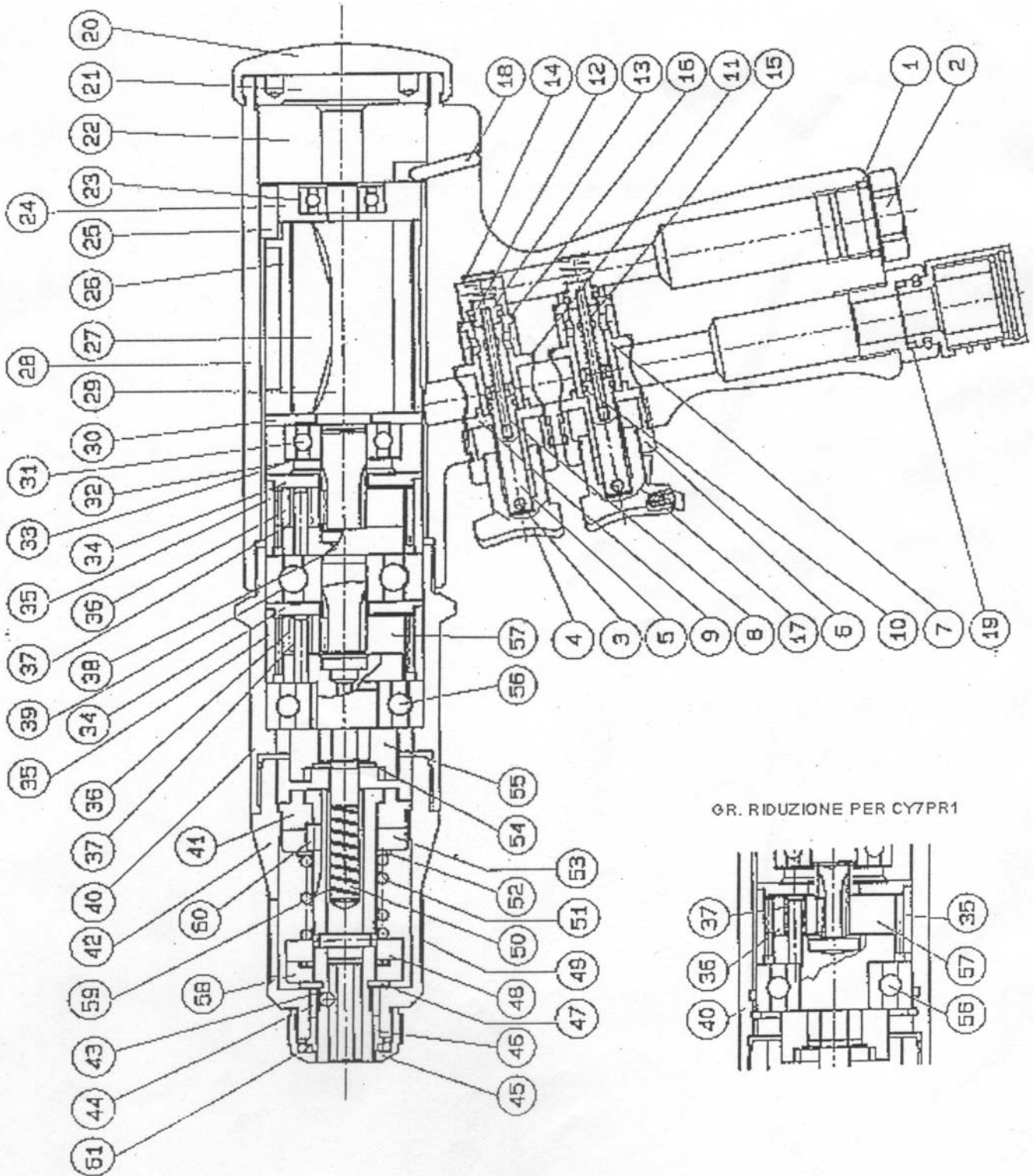

CALIDAD Y SERVICIO



ATORNILLADOR RECTO c/embrague M-8



Modelo: **CY 9 PR1**

CALIDAD Y SERVICIO

Nº	C. PROV.	CANT	DESCRIPCIÓN	DESCRIPCIÓN
1	530114017	1	Guarnizione	O-Ring
2	306371010	1	Sg. Raccordo	Connector assembly
3	525602012	2	Spina	Pin
4	214201251	1	Pulsante	Button
5	404590010	2	Valvola presa aria	Air valve
6	592620002	2	Ghiera	Nut
7	216505100	2	Sede valvola rev.	Rev. valve housing
8	598202820	2	Rullino	Pin
9	406537010	2	Guida valvola	Valve drive
10	530104010	2	Guarnizione	O-Ring
11	530116012	2	Guarnizione	O-Ring
12	530104417	2	Guarnizione	O-Ring
13	213050150	2	Valvola presa ana	Air valve
14	595100501	2	Molla	Spring
15	595100302	2	Molla	Spring
16	530111010	2	Guarnizione	O-Ring
17	314201251	1	Sg. Pulsante	Button assembly
18	549503014	1	Rullino	Pin
19	304878050	1	Sg. Silenziatore	Silencer assembly
20	404052010	1	Copritappo	Plug
21	592639002	1	Ghiera	Nut
22	406521010	1	Distributore	Distributor
23	541307030	1	Cuscinetto	Bearing
24	236505200	1	Flangia	Cylinder plate
25	522004012	1	Linguetta	Key
26	236505050	1	Camicia	Cylinder
27	236305300	5	Paletta	Vane
28	216512050	1	Corpo pistola	Pistol casing
29	236310100	1	Rotore per CY9PR1	Rotor for CY9PR1
	236301100	1	Rotore per CY7PR1	Rotor for CY7PR1
	236305100	1	Rotore per CY11PR1	Rotor for CY11PR1
30	236305150	1	Flangia	Cylinder plate
31	541010044	1	Cuscinetto	Bearing
32	406320020	1	Distanziale	Spacer
33	528025803	1	Anello compensatore	Condensator circlip
34	594811001	2	Distanziale	Spacer
35	246301100	1	Corona per CY7PR1	Gear ring for CY7PR1
	246301100	2	Corona per CY9PR1 e CY11PR1	Gear ring for CY9PR1/CY11PR1
36	246301050	6	Ing. satellite per CY9PR1	Gear wheel for CY9PR1
	246330150	6	Ing. satellite per CY11PR1	Gear wheel for CY11PR1
	246325150	3	Ing. satellite per CY7PR1	Gear wheel for CY7PR1
37	544003001	3	Gabbia a rulli per CY7PR1	Needle roller bearing for CY7PR1
	544003001	6	Gabbia a rulli per CY9PR1 e CY11PR1	Needle roller bearing for CY9PR1/CY11PR1
38	346350050	1	Sg. Gabbia media per CY11PR1	Planet shaft for CY11PR1
	346301050	1	Sg. Gabbia media per CY9PR1	Planet shaft for CY9PR1
39	541010058	1	Cuscinetto	Bearing
40	406365190	1	Prolunga per CY7PR1	Adaptor for CY7PR1
	406365200	1	Prolunga per CY9PR1 e CY11PR1	Adaptor for CY9PR1 and CY11PR1
41	256313100	1	Saltarello post.	Fixed sliding clutch

ATORNILLADOR RECTO c/embrague M-8



CALIDAD Y SERVICIO

Modelo: **CY 9 PR1**

Nº	C. PROV.	CANT.	DESCRIPCIÓN	DESCRIPCIÓN
42	406315150	1	Copertina	Clutch case
43	595620501	1	Molla	Spring
44	549003200	1	Sfera	Ball
45	403007080	1	Bussola	Bushing
46	403006020	1	Bronzina	Bushing
47	526310000	1	Anello	Circlip
48	304830030	1	Fermo di regola	Regolation clamp
49	595620505	1	Molla a fascía	Spring
50	354803150	1	Alberino	Spindle
51	595103504	1	Molla per CY9PR1	Spring for CY9PR1
	595104002	1	Molla per CY1 1 PR1	Spring for CY7PR1
	595102502	1	Molla per CY7PR1	Spring for CY11PR1
52	594814500	1	Rondella	Washer
53	253030050	1	Saltarello ant.	Sliding clutch
54	526307001	1	Anello	Circlip
55	406343010	1	Innesto	Coupling
56	541315058	1	Cuscinetto	Bearing
57	346320050	1	Gabbia terminale per CY9PR1	Planet shaft for CY9PR1
	346315050	1	Gabbia terminale per CY1 1 PR1	Planet shaft for CY11PR1
	346310050	1	Gabbia terminale per CY7PR1	Planet shaft for CY7PR1
58	4048390020	1	Ghiera	Nut
59	595500605	1	Molla	Spnng
60	598303206	3	Rullino	Pin
61	530115526	1	Guarnizione	O-Ring